



MantaMESH™



Wire Mesh Decking & Storage Accessories

WHY Wire Mesh Decking?

Safer	Better fire safety performance, meets stringent insurance requirements
More Durable	Does not warp, twist or sag: highly durable and maintenance free
Hygienic	Does not allow dirt or dust to build up
Easy to Handle	Quick and easy to install – no fixing or fastening
Improves Visibility	Increases lighting and access for operators
Versatile	Ideal for all storage, including coolrooms and freezers
Flexible	Allows you to store skids, pallets or small parts in any location

WHY MantaMESH™ ?

Proven Performance	The market leader for performance, innovation and value for money
Stronger	Unique 'Manta' support channel for extra strength
Australian-Made	Quality-approved materials and world-class manufacturing
Wide Range	Decks for all rack types and applications
Custom Design	Tailored for special applications
Flexible Application	Clip-on dividers for small parts storage and bulky retail
Available Australia-Wide	National Stockists and Resellers

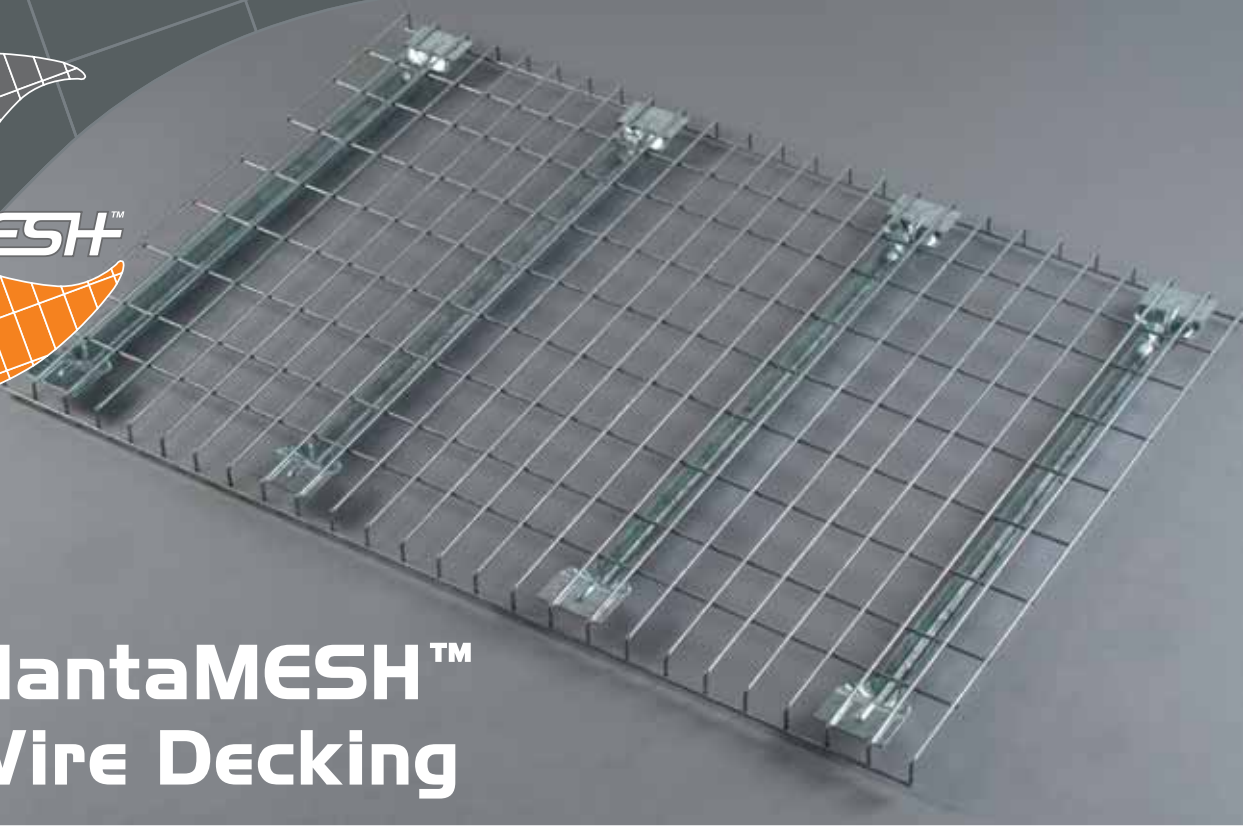
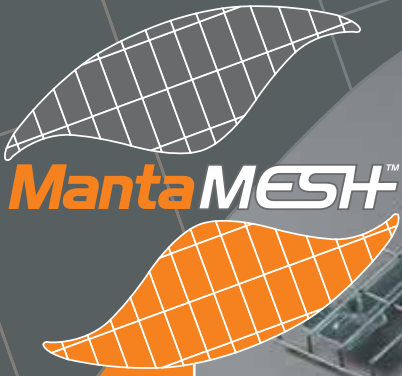

MantaMESH™ Wire Decking



Standard MantaMESH™ Deck

- Uniquely profiled “manta” supports for superior performance
- Suits all standard rack types, sizes, and configurations
- Can eliminate double handling and reduce pallet hire costs

Australian Design Registration No. 143675



MantaMESH™ Deck w/Inverted Channel

- Inverted channel prevents build-up of dirt or dust
- Improved hygiene and housekeeping: ideal for food and sterile environments
- Ideal for coolroom and freezer environments

Australian Design Registration No. 153884



Small Parts/Archive MantaMESH™

- Suitable for small parts, cartons and archive box storage
- Closer wire spacings prevents tipping between apertures
- Greater surface area for better load carrying performance

Australian Design Registration No. 143675



New SafeEDGE™

SafeEDGE™

- New design enhancement available on all standard MantaMESH™
- Improves OH&S by eliminating potential for operators to scratch hands or snag clothing on leading edge of wire mesh decks
- Particularly suited to narrow aisle or high-rise order picking applications

Australian Design Registration No. 143675

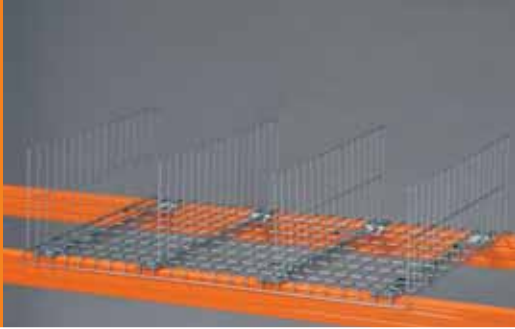

Divider System

MantaCLIP™

- Pre-welded MantaCLIP™ enables dividers to simply clip onto deck: fast, flexible and easy to adjust
- Ideal for order picking and bulky retail applications
- Better stock organisation and identification



Australian Design Registration No. 154320



Binning System

MantaCLIP™

- Improves efficiency and flexibility by increasing the number of available pick face locations
- Easy to install and reconfigure at any time: no tools required
- Suitable for small parts of all types



Australian Design Registration No. 154320



Particleboard Supports **MantaRAYL™**

- Uniquely-profiled galvanized steel particleboard supports for superior strength and performance
- Suitable for most rack beam-types including stepped beams
- Available with (left) or without (right) retainers



Australian Design Registration No. 153340

Australian Design Registration No. 147406



Easy to Install

MantaMESH™

- Safe, fast, easy to install and reconfigure: one man operation
- No tools, fixings or fastening required
- 'Manta' supports pre-welded to decks: no additional front to back support bars needed



Maximise Storage Efficiency & Flexibility

PROBLEM



SOLUTION



- Eliminates double handling
- Reduces pallet hire costs
- Improves work environment: prevents loose boards from catching on beams

PROBLEM



SOLUTION



- Improves safety: eliminates risk of pallet slip
- Improves operator efficiency
- Reduces product damage

PROBLEM



SOLUTION

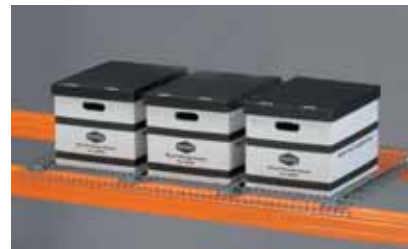

- Increases pick face locations
- Improves cleanliness
- Better access to cartons and easier to slide across deck

PROBLEM



SOLUTION



- Reduces pallet hire costs
- Improves efficiency and organisation
- Increases pick face locations

PROBLEM



SOLUTION



- Ideal for order picking and bulky retail
- Fully adjustable for excellent flexibility
- Improved stock organisation and identification

PROBLEM

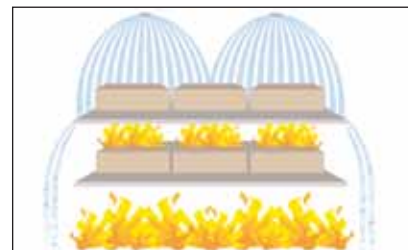

SOLUTION

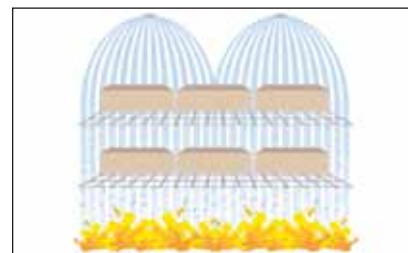

- Complies with FM Global specs for ESFR sprinklers with open shelving
- Allows for quick sprinkler activation and more effective penetration
- Meets stringent new fire and insurance requirements

MantaMESH™

32 Regent Crescent, Moorebank NSW 2170 (PO Box 633 Moorebank NSW 1875)
Telephone: +61 2 9734 6900 Facsimile: +61 2 9734 6711
Email: info@mantamesh.com.au Web: www.mantamesh.com.au
Australian Design Registration Nos: 143675, 153884, 147406, 154320 & 153340

MantaMESH™, SafeEDGE™, MantaCLIP™, MantaRAVL™ are trademarks of Delta Shelving Systems Pty Ltd ABN 51 082 565 357
© Copyright Delta Shelving Systems Pty Ltd

MantaMESH™ Distributor: